

*This map is NOT true to scale but is an overall reflection of the campus layout for wayfinding use.

HOUSTON HEALTHCARE (WARNER ROBINS)

SUNSET DRIVE

FIRST FLOOR

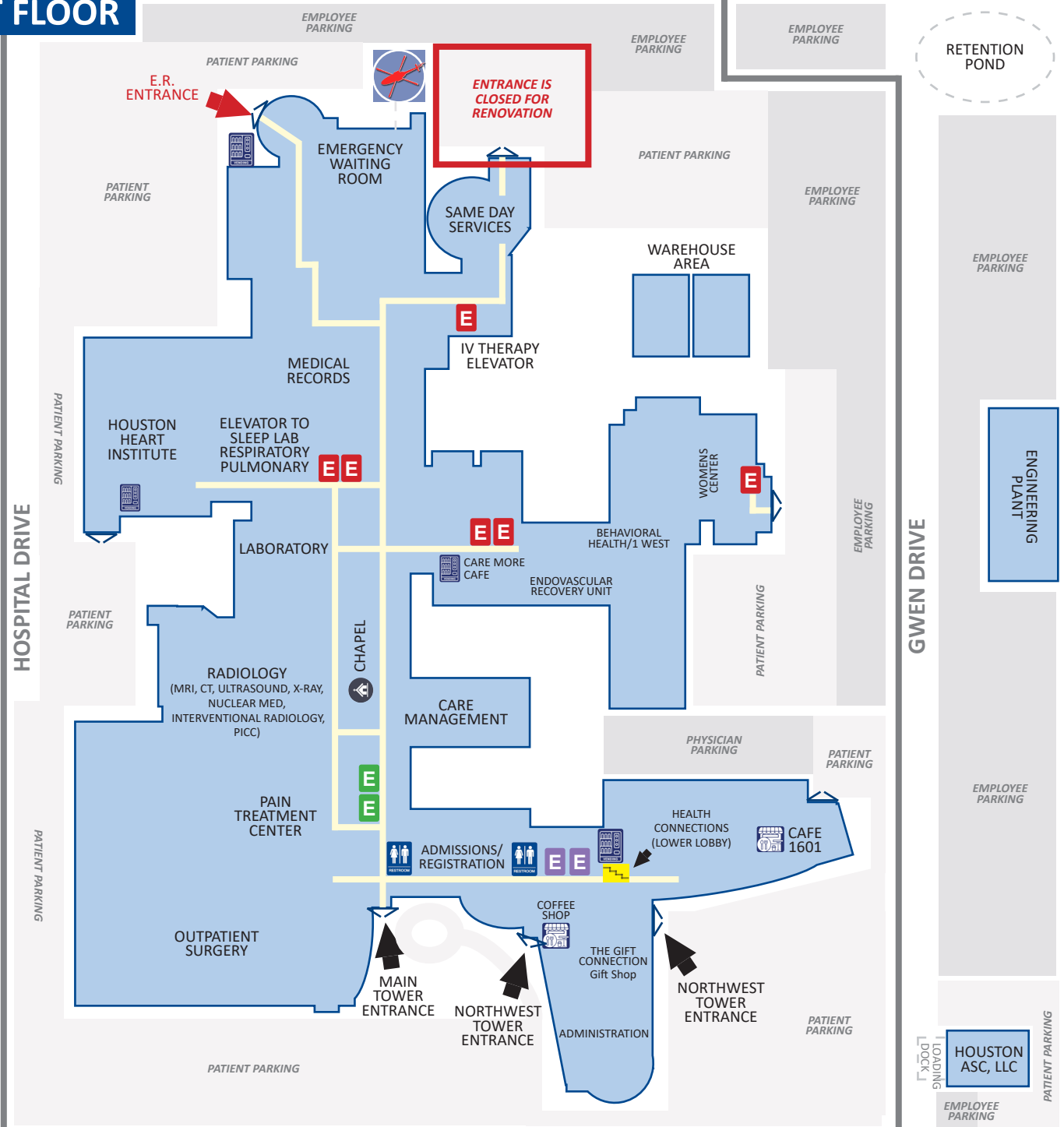

WATSON BOULEVARD

HUMAN RESOURCES

PARKWOOD DRIVE

MAP KEY

= WALKWAY/ACCESS	= CHAPEL
= HALLWAY/OPEN AREA	= FOOD/DRINK
= RESTROOM	= VENDING
= DOOR/ACCESS	= ELEVATORS / MAIN TOWER
= ELEVATORS / NORTHWEST TOWER	= ELEVATORS / EAST
= STAIRS	= HELICOPTER

MAIN TOWER ELEVATORS:

2ND - SECOND FLOOR	
2 MAIN / ACUTE MEDICAL	Rooms 201-238
DIALYSIS	Rooms 2E1-2E8
PEDIATRICS	Rooms 239-248
WOMENS CENTER	Rooms 251-269
3RD - THIRD FLOOR	
3 MAIN / PULMONARY	Rooms 301-332
3 EAST	Rooms 3E1-3E8
4TH - FOURTH FLOOR	
4 MAIN / CARDIOVASCULAR	Rooms 401-440
<i>Main Tower 3rd & 4th Floors Are Patient Rooms Only</i>	

NORTHWEST TOWER ELEVATORS:

2ND - SECOND FLOOR	
2 NORTH / GENERAL SURGICAL	Rooms 6201-6218
2 WEST / POST PARTUM & NURSERY	Rooms 6219-6234
4TH - FOURTH FLOOR	
4 NORTH / INTERMEDIATE CARE	Rooms 6401-6414
4 WEST / CRITICAL CARE	Rooms 6415-6432
5TH - FIFTH FLOOR	
5 NORTH / SURGICAL	Rooms 6501-6518
5 WEST / ORTHOPAEDIC	Rooms 6519-6536

FLIP MAP TO SEE SECOND FLOOR

*This map is NOT true to scale but is an overall reflection of the campus layout for wayfinding use.

HOUSTON HEALTHCARE (WARNER ROBINS)

SUNSET DRIVE

SECOND FLOOR

HOSPITAL DRIVE

GWEN DRIVE

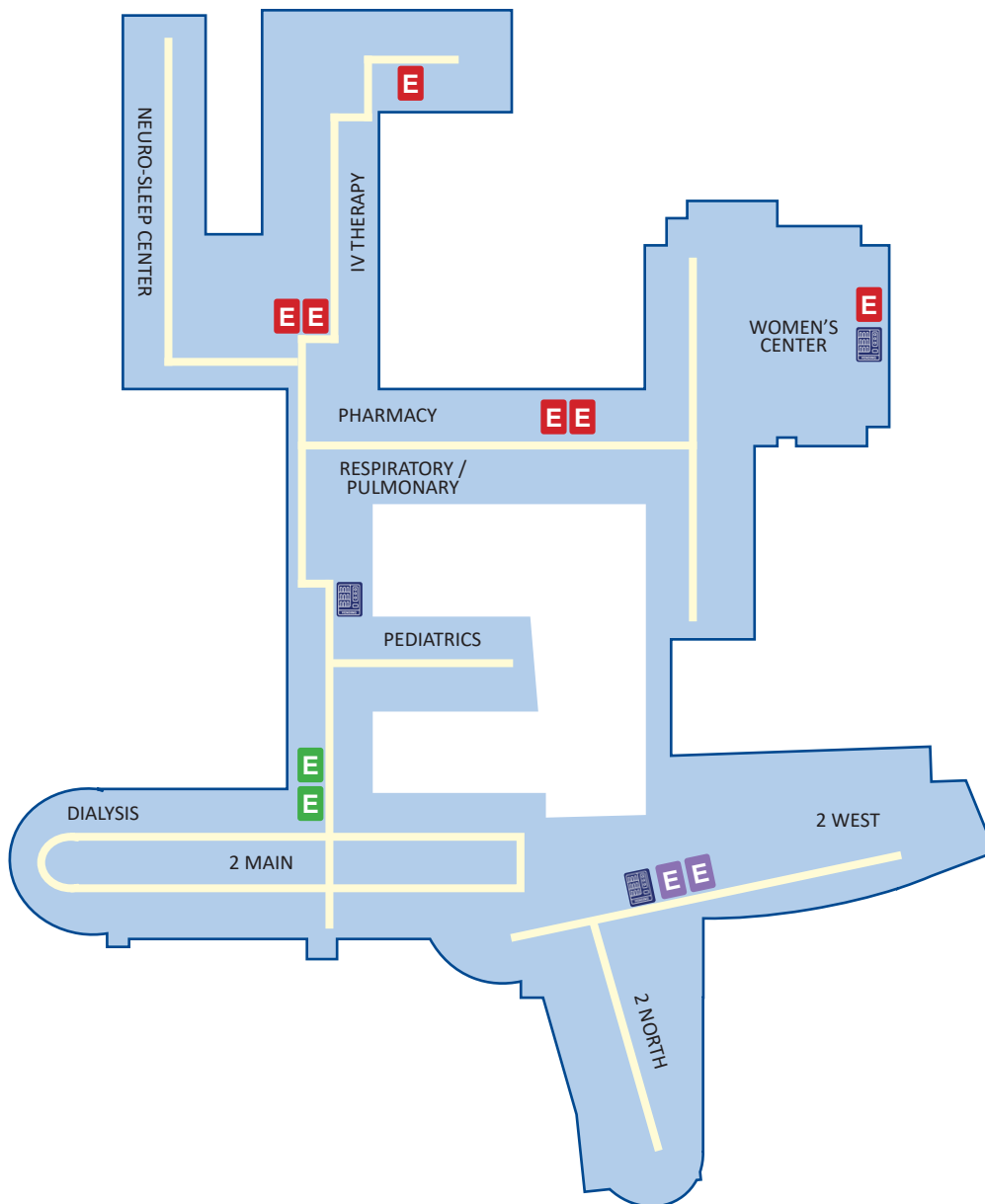

WATSON BOULEVARD

PARKWOOD DRIVE

MAP KEY	= WALKWAY/ACCESS	MAIN TOWER ELEVATORS:	
	= HALLWAY/OPEN AREA	2ND - SECOND FLOOR	
= RESTROOM	= VENDING	= FOOD/DRINK	2 MAIN / ACUTE MEDICAL Rooms 201-238
= DOOR/ACCESS	= ELEVATORS / MAIN TOWER	= ELEVATORS / NORTHWEST TOWER	DIALYSIS Rooms 2E1-2E8
= ELEVATORS / EAST	= STAIRS	= HELICOPTER	PEDIATRICS Rooms 239-248
			WOMENS CENTER Rooms 251-269
			3RD - THIRD FLOOR
			3 MAIN / PULMONARY Rooms 301-332
			3 EAST Rooms 3E1-3E8
			4TH - FOURTH FLOOR
			4 MAIN / CARDIOVASCULAR Rooms 401-440
			<i>Main Tower 3rd & 4th Floors Are Patient Rooms Only</i>
			NORTHWEST TOWER ELEVATORS:
			2ND - SECOND FLOOR
			2 NORTH / GENERAL SURGICAL Rooms 6201-6218
			2 WEST / POST PARTUM & NURSERY Rooms 6219-6234
			4TH - FOURTH FLOOR
			4 NORTH / INTERMEDIATE CARE Rooms 6401-6414
			4 WEST / CRITICAL CARE Rooms 6415-6432
			5TH - FIFTH FLOOR
			5 NORTH / SURGICAL Rooms 6501-6518
			5 WEST / ORTHOPAEDIC Rooms 6519-6536